

All for your service needs!



INSTRUCTION MANUAL

Shock wave physiotherapy massager



SHOCK WAVE PHYSIOTHERAPY MASSAGER

Dear users, hello!

We would like to thank you for your choice of our well-designed and manufactured equipment. In order to give full play to the functions of our products, we sincerely suggest that:

1. Before using the device, please read the manual carefully and keep it for future reference
2. Please use and operate correctly according to the requirements in the manual
3. Do not disassemble or modify any parts of this machine;
4. Except authorized personnel of the company, it is strictly prohibited for others to open the machine cover and the main engine;
5. It is strictly forbidden for non-professional personnel to carry out maintenance and transformation without authorization
6. Please contact us if there is any malfunction during the operation.

1、Product parameters of pneumatic impact massager

1.1 ML11 product parameters

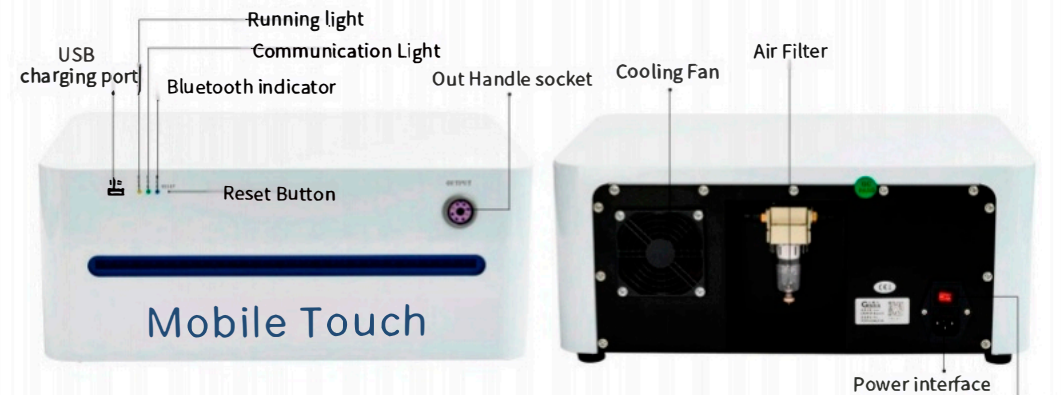

Note: The transparent air filter at the back of the Instrument should be pressed upward to drain the water.

One-to-one Bluetooth Pairing, smart control panel (10.1 inch tablet)

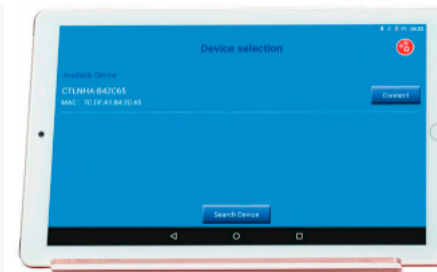

10.1 inches

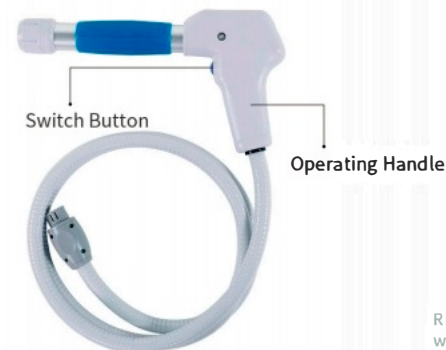

- 1 # effective diameter of head center = 6MM,
- 2 # effective diameter of head center = 10MM,
- 3 # effective diameter of head center = 15MM,
- 4 # effective diameter of head center = 20MM,
- 5 # effective diameter of head center = 25MM.

REMARKS: Please turn off the power switch of the Instrument when changing the working head or unplugging each plug!



Model: ML11	Color: White
Voltage: AC110V/AC220V(Automatic switching)	Frequency: 50Hz/60Hz
Power: 350W MAX	Current: 5A MAX
Working intensity: 0.5-10.0Bar	Operating frequency: 01-22Hz
Number of jobs: 500-3000 times	Number of working heads: 5
Instrument size: 450*309*196mm	Packing size: 730*520*310mm
Net weight: 17.868kg	Gross weight : 26.958kg

1.2 basic operation of pneumatic shock wave

1.2.1 instrument connection

(1) Check with the packing list whether the machine parts are complete and in good condition.

(2) After the accessories are arranged, insert the multi-core plug at the end of the connecting line into the OUT socket on the front of the host device. Be Sure to align and re-insert the multi-core plug bump with the multi-core socket notch to avoid permanent damage to the instrument.

(3) Plug the host power cord into the power socket at the back of the host device.

(4) Select a suitable working head, one hand holding the handle, the other hand along (counterclockwise) direction of the working head from the handle, and then the need to work along (clockwise) direction firm.

(5) Turn on the main power switch at the back of the host device.

(6) Press the switch button on the handle or the start button on the screen, the machine will enter the working state.

(7) Operate handle a key switch, press open, then close.



Note:

You have to plug in the handle to operate the touch panel

Do not pull OUT the OUT socket directly when the massage handle is switched on.

Turn off the power and wait for about 15 seconds before pulling OUT the handle.

1.2.2 introduction to password protection settings

When the power is turned on, the instrument will enter the ready-to-start state. The initial password is 23456.

1.2.3 Language setting

Operation Interface can switch 4 languages, are: Simplified Chinese, traditional Chinese, English, Spanish. (QT02 is currently available in only Chinese and English)

1.2.4 Parameter setting

(1) touch [yes, I understand] then go to the feature selection screen and select the corresponding position mode.

(2) set appropriate operating frequency.

1.2.5 operating mode

(1) skin cleansing of the massage area.

(2) choose suitable head according to the nursing site.

(3) evenly spread the gel over the massage area.

(4) During the operation, the operator shall hold the handle in his hand and place the working head on the nursing part. Because the handle itself has a certain weight. So there is no pressure on her as if she were nursing.

(5) Wipe off the residue on the skin with a hot towel after care; clean the head with a wet towel.

1.3.6 Half-way stop

(1) interrupt operation by pressing the "start/stop" button on the home screen

(2) can also be closed by pressing the handle button.

1.3 Method of Replacement Bullet



1. twist the work head from the front of the working handle .

2. With the working handle facing down, hitting the working headle and the bullet will come out.

3. Put the new bullet into the working handle, and then tighten the working headle.

2、 Suggestions for operation of shock wave instruments

2.1 Operational positioning

- (1) Pain location: find pain points by pressing. Pain points usually mean local soft tissue injury or soft tissue adhesion, which requires shock wave physiotherapy for targeted pain points.
- (2) Associated Muscle origin and destination: for patients with soft tissue tension or muscle spasms, either directly in the middle of the pain point or during intraabdominal treatment may cause more injury or spasm, when the alternative is to strike both ends, it can relieve the tension of the soft tissue
- (3) touch localization: There are ligature or induration points in the area, which can also be used as physical therapy points, these areas suggest internal muscle spasm and adhesion, usually accompanied by some pain symptoms.
- (4) the location of articular capsule destruction: If the FEMORAL head necrosis patient, can in the hip joint capsule body surface projection area, carries on the dense strike, uses the human body repair mechanism to rebuild the area circulation, increases the nutrition supply.

2.2 Indications for shock wave therapy

Plantar fasciitis or plantar fasciitis, humerus condyle inflammation, rotator cuff tendon lesions, biceps oil tendinitis, peri arthritis of shoulder, tennis elbow, golf elbow, Achilles tendinitis, patellar tendinitis, knee osteoarthritis, Gu tendinitis, heel bone spurs, delayed fracture healing and bone non-union, big rotor slippery bursa phlogistic, cramps, chronic hyperplastic wound and delay wound healing and don't heal, the other end of the tendon sheath Disease, early femoral head necrosis.

2.3 The taboo of shock wave physiotherapy

- (1) patients with heart disease, cardiac pacemaker, hypertension;
- (2) patients with acute inflammation, deep vein thrombosis, Goiter, asthma, cancer, etc. ;
- (3) patients with ruptured blood vessels and bleeding, trauma, bleeding wound;
- (4) pregnant women;
- (5) areas with plastic surgery and artificial implants;
- (6) people with metal materials (including metal teeth) ;
- (7) people with inflammation of the skin and body edema;
- (8) people with abnormal immune system function;
- (9) people who feel numb and unresponsive to heat;
- (10) Do not support use in the vicinity of certain tissues, such as eyes and surrounding areas, myocardium, spinal cord, gonad, renal marrow and liver;
- (11) people who have blood disorders, clotting problems or use of anticoagulants;
- (12) Polyp near the nursing site;
- (13) thrombotic, neoplastic, polyneuropathy;
- (14) growing cartilaginous children;
- (15) site of corticosteroid therapy;
- (16) not supported for use in parts or organs of the body that contain large amounts of gas;
- (17) it is not recommended for use in the presence of a large number of nerves, blood vessels, Crista and the head.

2.4 Points to note

2.4.1 Use caution

- (1) although internal resistance is high due to the weight and design of the working head, constant vibration may cause tension in the user's hands.
- (2) to prevent heat from accumulating in the vent, hands or objects should not cover the vent.
- (3) The projectile body is consumable and must be replaced after hitting for a certain time.
- (4) in case of special circumstances or accidents, please stop using it immediately and consult a professional.
- (5) switch off the power supply immediately and stop using it if the following abnormal situation occurs during use;

- Water and foreign body into the body;
- Body, power cord, accessory wire and plug abnormal heating, leakage.
- Abnormal Sound;
- Abnormal smell and smoke;
- Damage to any accessories;
- The sudden occurrence of natural disasters such as thunder and earthquake.

(6) after use, to cut off the power supply, do not use must pull the plug from the power outlet.

(7) Please take care of it. Power Cord and accessory wire should be carefully checked before each use. If there is any sign of damage, stop using and replace the new parts.

(8) Medical equipment or household appliances located close to the instrument may malfunction due to interference.

(9) Do not use impact massager in hot and humid environment, dusty environment, Oily Fume or water vapor environment.

(10) in the event of failure in use, should immediately turn off the power supply, must be dismantled by professionals, maintenance or sent to dealers, manufacturers maintenance, not self-repair.

(11) exemption from liability

The company shall not be liable for:

- Because of fire, earthquake, war and other irresistible circumstances;
- Due to the fault of the user, Error Operation;
- Damage caused by methods of use other than those in this manual.

(12) Please keep away from the wall when the instrument is in use. Keep 30CM space around the instrument for heat dissipation.

(13) This instrument is a massage instrument, not a medical instrument.

2.4.2 Possible side effects

- (1) there may be congestion or swelling in the nursing area.
 - (2) the skin of the care unit may feel itchy or temporarily numb.
 - (3) the impact massager nursing has certain damage to the skin after the hormone treatment.
 - (4) shock massage may cause the heart to temporarily beat abnormally.
- repair, to prevent the expansion of the failure, the occurrence of safety accidents.

2.5 Application suggestions

2.5.1 ED Treatment

(1) the frequency of ED therapy is 1 -- 10 Hz, and the recommended frequency is 3 -- 8 hz.

(2) please adjust the energy according to the customer's requirement, operating from low to high.

2.5.2 Apply physical therapy advice

The user can adjust the energy level and frequency according to the severity of the damage

Apply physical therapy advice					
Region	Frequency/level	Hit Count	Working hours	Total hits	Interval time
Elbow	3Hz/70mj	2,000-2,500	3-5Minutes	6,000-12,500	5-7days
Hand/wrist	1Hz/70mj	2,000	3-5Minutes	6,000-10,000	5-7days
Pubic symphysis	3Hz/90mj	2,000-2,500	5Minutes	6,000-12,500	Daily 1 day
Knee	3Hz/90mj	2,000	3-5Minutes	6,000-10,000	5-7days
Feet/ankles	3Hz/70mj	1,000	3-5Minutes	30,00-5,000	1 days
Shoulder	6Hz/120mj	2,000-2,500	3-5Minutes	6,000-12,500	5-7days
Lumbar Vertebra	8Hz/150mj	2,000-2,500	3-5Minutes	6,000-12,500	5-7days
Fat Accumulation	10Hz/150mj	2,000-2,500	5Minutes	6,000-12,500	5-7days
Buttocks	4Hz/180mj	2,000-2,500	5Minutes	6,000-12,500	5-7days

2.6 Shock Wave Instrument maintenance

2.6.1 Check before use

Before using the shock wave physiotherapy device, the following examinations should be carried out:

- Check for any mechanical damage;
- check all exposed wires, inserts and fittings;
- check all possible body functions of the instrument and ensure that it is in good working condition.

2.6.2 Shock wave product maintenance and repair

(1) the shock wave physiotherapy apparatus is a general mechanical and electronic product with a service life of 10 years under normal working conditions (the warranty period is 1 year) .

(2) the user should wipe and clean the dust on the surface of the physiotherapy instrument at least once a week. Wipe with a clean cloth or soft brush can be clean, alcohol, gasoline or other cleaning agent is prohibited, wipe the host and physiotherapy handle, prohibit the flow of liquid into the internal physiotherapy instrument.

(3) regular maintenance of the head and accessories can improve its service life. It is recommended that the head be maintained every other month.

(4) physical therapy instrument failure, to timely shutdown, by professional maintenance personnel to repair, to prevent the expansion of the failure, the occurrence of safety accidents.

2.6.3 Maintenance method of airframe and handle of pneumatic shock wave instrument

(1) under normal use conditions, the replacement cycle of the warhead kit is 25,000,000 times, if not replaced in time, may cause product defects. The method is: Twist down the working head of the front end of the operating handle, put the operating handle down on the desktop, knock down slightly to drop the projectile body, put the new projectile body into the operating handle, then twist up the working head to complete the replacement.

(2) when the handle is maintained, drop 2 drops of clean lubricating oil into the Middle Missile Tube at the front end of the handle and keep the handle facing up for 3 minutes.

▲Note: When changing the bomb body or maintaining the operating handle, the power must be cut off before pulling out the operating handle.

2.6.4 fault diagnosis (for reference only)

Failure phenomenon	Cause of failure	Method of elimination
Turn on the main power switch, the display screen is not bright, physical therapy instrument no response	Poor contact of power cord and plug	Check whether the power cord, plug, etc. are plugged in
Turn on the power pressure pump operation, but the pressure does not rise or rise	Air Pump air filter dirty or blocked	Drain the air and moisture from the Air Valve
Working hair makes abnormal noise or does not run	1. The working head is damaged 2. Warhead Jammed Replacement Kit 3. Damage or wear of ballistic tubes and warhead assemblies	Replacement of work head or warhead kit
Display mode or display random code	Power supply voltage instability or strong electromagnetic interference	Check the power supply, if necessary, take voltage-stabilizing measures, away from strong electromagnetic radiation



Warning: except for medical device manufacturers and after-sales service centers, users are advised not to dismantle and modify the physiotherapy equipment by themselves. This will cause abnormal operation of the physiotherapy equipment, resulting in accidents and injuries.

If there is a need for maintenance, the manufacturer may be requested to provide the circuit diagram, list of components, drawings, notes, calibration details, or other information necessary to assist the user's qualified technical personnel in repairing the repairable parts of the equipment designated by the manufacturer, and under the guidance of the manufacturer for maintenance.

2.6.5 special storage and transport conditions and methods

- Ambient temperature: -10 °C-55 °C. Relative humidity ≤ 85% .
- Atmospheric Pressure: 500 HPA ~ 1060 HPA
- Packaging requirements: shockproof materials and moisture proof plastic bags.
- Handling Requirements: attention to handle gently, prohibit box rolling.
- Transportation Requirements: prevent impact, extrusion, damp, violent vibration.
- Storage requirements: When the machine is not used for a long time, it should be packed and stored in a cool, dry, well ventilated room without corrosive gas.

3、The Adjuster

3.1 Scope of free service

All equipment within the scope of warranty service conditions of the company can enjoy free service.

3.2 Fee Charging Service area

(1) the company will charge for the service of any equipment beyond the scope of the company's Warranty Service Conditions;

(2) During the warranty period, the products need to be repaired due to the following reasons: artificial damage, power grid voltage beyond the specified range of equipment, irresistible natural disasters, etc. .

We hereby assume no responsibility for direct, indirect or ultimate damage or delay caused by improper use, replacement of parts not approved by us or repair of machines by persons not authorized by us, including but not limited to.

Note: The contents of this manual are for reference only. The final analysis and modification rights belong to the manufacturer.